

APPROVED MINUTES



**ACME TOWNSHIP PARKS & TRAILS COMMITTEE
MEETING
6042 Acme Road
US 31 N Williamsburg, MI 49690
September 19, 2022 4:00 p.m.**

CALL TO ORDER at 4:04 p.m.

ROLL CALL

Committee Members present: Jenema, DeVogel, Wielenga, Schmitz

Committee Members excused: Morrison, Huffer, LaPointe

Advisory present: None

Staff present: L. Wolf, Planning & Zoning Administrator, R. Lamott

A. PUBLIC COMMENT: None

B. APPROVAL OF AGENDA

Motion by Jenema supported by DeVogel to approve the Agenda as presented. No discussion. Voice vote. Motion carried unanimously.

C. INQUIRY AS TO CONFLICTS OF INTEREST: None

D. CORRESPONDENCE: None

E. ACTION:

1. Approve *Draft Parks & Trails Minutes 09.19.2022*

Motion by Jenema, supported by DeVogel, to approve the *Draft Parks & Trails Minutes 09.19.2022* as presented. No discussion. Voice vote. Motion carried unanimously.

F. OLD BUSINESS:

1. Bayside Playground Expansion

Wielenga is waiting for a response on the estimates. The committee will meet again to discuss once received to bring to the board for winter. Schmitz was brought up to date.

2. Trails update

A ribbon cutting ceremony will be held on October 25th. Parking locations for the trail at Bayside and Meijer were discussed. Wolf will email the committee the time and location of the ribbon cutting.

3. Update on Wet Garden

Update to be provided at a future meeting.

4. Election of Officers

Jenema nominates DeVogel for secretary, seconded by Schmitz. No discussion. Voice vote. Motion carried unanimously.

G. NEW BUSINESS

1. Projects for Eagle Scouts

1. Flag retirement -ongoing
2. Stripping and staining of signs at Yuba and Tobeco
3. Bayside sign mounted on building – Scout project

4. Strip and seal picnic tables at Sayler and Bayside
5. Pavilion at Bayside – remove lattice, strip, seal, bracing
6. Benches at nature preserve – rebuild backed bench
7. Redo bird houses and posts at nature preserve – types of houses and bat boxes
8. Paint bath house doors with township logo
9. Kiosk at upper and lower nature preserve – update with posters
10. Bayside clean up/parks clean up
11. Staining and water sealing upper and lower nature preserve fences
12. Benches at Sayler – welding class project

H. PUBLIC COMMENT: None

ADJOURN: Motion by Jenema, supported by Schmitz to adjourn. No discussion. Voice vote. Motion carried unanimously.

Meeting adjourned at 4:52 p.m.

Respectfully,
Lindsey Wolf



ACME TOWNSHIP PARKS & TRAILS MEETING
Acme Township Hall
6042 Acme Road Williamsburg, MI 49690
September 19, 2022 4:00 p.m.

ROLL CALL:

Committee:

	Huffer		Jenema		LaPointe		DeVogel
	Schmitz		Morrison		Wielenga		
Advisory:	Kushman		Lamott				
Staff:	Wolf						

A. PUBLIC COMMENT:

B. APPROVAL OF AGENDA:

C. INQUIRY AS TO CONFLICTS OF INTEREST:

D. CORRESPONDENCE:

1. None

E. ACTION:

1. Approve Draft Parks & Trails Minutes 8.15.202

F. OLD BUSINESS:

1. Bayside Playground Expansion
2. TART Trails Update
3. Wet Garden update
4. Election of Officers – Secretary

G. NEW BUSINESS:

1. Projects for Scouts, Honor Students, Etc.

H. PUBLIC COMMENT

ADJOURN:



DRAFT UNAPPROVED

**ACME TOWNSHIP PARKS & TRAILS COMMITTEE
MEETING
Bayside Park
US 31 N Williamsburg, MI 49690
August 15, 2022 4:00 p.m.**

CALL TO ORDER at 4:01 p.m.

ROLL CALL

Committee Members present: Morrison, LaPointe, Jenema, DeVogel, Wielenga

Committee Members excused: Wentzloff, Huffer

Advisory present: None

Staff present: L. Wolf, Planning & Zoning Administrator

A. PUBLIC COMMENT: None

B. APPROVAL OF AGENDA

Motion by Jenema supported by LaPointe to approve the Agenda as modified with the addition of G## Solar Light at Sayler. No discussion. Voice vote. Motion carried unanimously.

C. INQUIRY AS TO CONFLICTS OF INTEREST: None

D. CORRESPONDENCE: None

E. ACTION:

1. Approve *Draft Parks & Trails Minutes 07.18.2022*

Motion by LaPointe, supported by Jenema, to approve the *Draft Parks & Trails Minutes 07.18.2022* as presented. No discussion. Voice vote. Motion carried unanimously.

F. OLD BUSINESS:

1. Bayside Playground Expansion

The Committee continued their discussion of the expansion of the playground at Bayside Park. Specifically, the location of 30'x40' near the garden. Motion by Wielenga, supported by Morrison. No discussion. Voice vote. Motion carried unanimously.

2. Trails update

Wolf explained the delay in the bridge arrival until the end of the month. Tentative completion date of beginning of October.

3. Update on Wet Garden

LaPointe asked about the budget, installation of boulders, standpipe. Committee discussed wet garden phases: rocks, water, fountain. Discussion on running a line was had. LaPointe will follow up. Motion for boulders and standing water by Wielenga, supported by LaPointe. No discussion. Voice vote. Motion carried unanimously.

G. NEW BUSINESS

1. Life Jacket Library

Committee discussed location near the swing bench closest to the beach. Motion by Morrison, supported by Wielenga. No discussion. Voice vote. Motion carried unanimously.

2. Election of Officers

Jenema nominates Wielenga for Chair, supported by Lapointe. No discussion. Voice vote. Motion carried unanimously.

Jenema nominates Morrison for Vice Chair, supported by Lapointe. No discussion. Voice vote. Motion carried unanimously.

Secretary will be brought back at the next meeting.

3. Solar Light at Sayler

Discussion on location. Wielenga and Morrison will work with Supervisor White to determine location and number of lights.

H. PUBLIC COMMENT:

Wielenga and Morrison inquired on enforcement of fees for boat launch. Will contact Supervisor White to have the deputy regulate parking during events. Discussion on township and county overlap for parks. Location of cedar swing at Sayler set next to play ground and not beach.

ADJOURN: Motion by Jenema, supported by Wielenga to adjourn. No discussion. Voice vote. Motion carried unanimously.

Meeting adjourned at 5:07 p.m.

Respectfully,
Lindsey Wolf



563 College Avenue, Holland, MI 49423
 Ph: 616-395-2565 or 800-685-6291
 Fx: 616-395-2556
 Email: heathervk@playenviro.com

Acme Twp Bayside Park

BILL TO:

Acme Twp
 ATTN: Nate & Mat
 6042 Acme Road
 Williamsburg MI 49690
 Contact e-mail

REVISED QUOTE

R5 Pole's

10/4/2021

SHIP TO:

Acme Twp
 6042 Acme Road
 Williamsburg MI 49690
 PHONE (231) 938-1350
 FAX (231) 938-1510

QTY	MODEL NUMBER	VND TX	DESCRIPTION	WEIGH'	UNIT PRICE	EXT. PRICE
1		PC	2-5 Structure R5 Pole's		17,458.00	17,458.00
1	A2-2123-PSX2	PC	Arch Swing 2 Playshare		4,087.00	4,087.00
1	A2-1384	PC	Fish Spring Rider		1,111.00	1,111.00
1	A2-2181-2B	PC	Single Post Swings 2 Belts		1,561.00	1,561.00
1	A2-2181-2B-AB	PC	Single Post Swings 2 Belts Add-A-Bay		1,228.00	1,228.00
4	S-1961-R	PC	Rock Step		196.00	784.00
1	A2-2435-W	PC	Boardwalk, Wave		1,195.00	1,195.00
1		PC	5-12 Structure R5 Pole's		35,871.00	35,871.00
1	A2-2495	PC	Merry-Go-Round		8,367.00	8,367.00
1	A2-2485	PC	Neutron Spinner		3,598.00	3,598.00
1	A2-1395	PC	Dual Airplane Spring Rider		1,993.00	1,993.00
1		PC	Freestanding Surf Rider		1,391.00	1,391.00
1	Surcharge	PC	Material Surcharge		10,184.00	10,184.00
1	Freight		Freight to Williamsburg MI		10,000.00	10,000.00
					-	-
9 Days		PS	Equipment Installation		2,000.00	18,000.00
200 Units		PS	Concrete		6.00	1,200.00
					-	-
342 LF		PS	Concrete Curb		50.00	17,100.00
					-	-
3 Rolls		HN	Geo Fabric		423.00	1,269.00
3 Install		PS	Geo Fabric Installation		188.00	564.00
					-	-
320 Yards		MWF	EWF		13.00	4,160.00
2 Delivery		MWF	EWF Delivery		938.00	1,876.00
320 Yards		PS	EWF Installation		6.00	1,920.00
					-	-

COMMENTS: Prices good for 30 days w/2021 Delivery.
 THE PRICE DOES NOT INCLUDE: TAX, UNLOADING, TRASH REMOVAL
 SURFACING, SITE WORK, INSTALLATION, OR BAD DIGGING CONDITIONS
UNLESS SPECIFICALLY QUOTED.

SUB-TOTAL: 144,917.00
 DISCOUNT: 9,917.00

TOTAL: \$ 135,000.00

SIGNED: _____ ACCEPTED BY: _____
 Joshua Cartwright

MAKE PURCHASE ORDERS OUT TO: Play Environments Design, 563 College, Holland, MI 49423
 Acceptance of this quote indicates your agreement to abide by Play Environments Design terms of sale
 TERMS: TBD

Acme Twp, Bayside Park

Project No. 08152021



Presented By

Play Environments Design, LLC

and



Acme Twp, Bayside Park

TOP VIEW

ADA ACCESSIBILITY GUIDELINE - ADAAG CONFORMANCE

ELEVATED	ACCESSIBLE	RAMP ACCESSIBLE	GROUND	TYPES
0	0/0	0	2/0	1/0

FOR KIDS
AGES
5-12

GENERAL NOTES:

This conceptual plan is based on information provided prior to construction. Detailed site information, including the following, should be obtained, evaluated, and utilized in the final project design. Exact site dimensions, topography, existing utilities, soil conditions and drainage solutions.

WARNING: Accessible safety surfacing material is required beneath and around this equipment that has a critical height value (Fall Height) appropriate for the highest accessible part of this equipment. Refer to the CPSC'S Handbook For Public Playground Safety, Section 4: Surfacing.

PC 2123
Arch
Swing
(2PS)

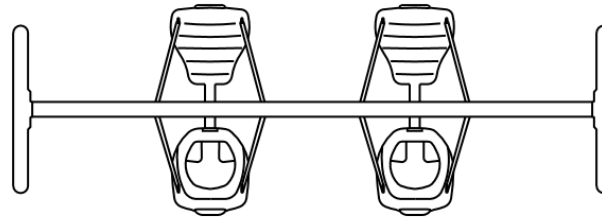

STRUCTURE#: 2
PROJECT#: 08152021
DATE: 10/10/2021

MIN. USE ZONE: 24' x 31'

PLAYCRAFT REP:
Play Environments Design, LLC

Acme Twp, Bayside Park

TOP VIEW

ADA ACCESSIBILITY GUIDELINE - ADAAG CONFORMANCE

ELEVATED	ACCESSIBLE	RAMP ACCESSIBLE	GROUND	TYPES
0	0/0	0	1/0	1/0

FOR KIDS
AGES
2-5

GENERAL NOTES:

This conceptual plan is based on information provided prior to construction. Detailed site information, including the following, should be obtained, evaluated, and utilized in the final project design. Exact site dimensions, topography, existing utilities, soil conditions and drainage solutions.

WARNING: Accessible safety surfacing material is required beneath and around this equipment that has a critical height value (Fall Height) appropriate for the highest accessible part of this equipment. Refer to the CPSC'S Handbook For Public Playground Safety, Section 4: Surfacing.

PC 1384
FISH
SPRING
RIDER



STRUCTURE#: 3
PROJECT#: 08152021
DATE: 10/10/2021

MIN. USE ZONE: 13' x 15'

PLAYCRAFT REP:
Play Environments Design, LLC

Acme Twp, Bayside Park

TOP VIEW

ADA ACCESSIBILITY GUIDELINE - ADAAG CONFORMANCE

ELEVATED	ACCESSIBLE	RAMP ACCESSIBLE	GROUND	TYPES
0	0/0	0	4/0	1/0

FOR KIDS
AGES
5-12

GENERAL NOTES:

This conceptual plan is based on information provided prior to construction. Detailed site information, including the following, should be obtained, evaluated, and utilized in the final project design. Exact site dimensions, topography, existing utilities, soil conditions and drainage solutions.

WARNING: Accessible safety surfacing material is required beneath and around this equipment that has a critical height value (Fall Height) appropriate for the highest accessible part of this equipment. Refer to the CPSC'S Handbook For Public Playground Safety, Section 4: Surfacing.

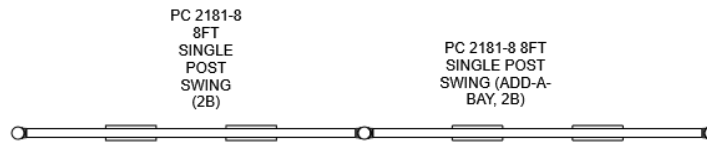

STRUCTURE#: 4
PROJECT#: 08152021
DATE: 10/10/2021

MIN. USE ZONE: 36' x 31'

PLAYCRAFT REP:
Play Environments Design, LLC

Acme Twp, Bayside Park

TOP VIEW

ADA ACCESSIBILITY GUIDELINE - ADAAG CONFORMANCE

ELEVATED	ACCESSIBLE	RAMP ACCESSIBLE	GROUND	TYPES
0	0/0	0	5/0	1/0

FOR KIDS
AGES
5-12

GENERAL NOTES:

This conceptual plan is based on information provided prior to construction. Detailed site information, including the following, should be obtained, evaluated, and utilized in the final project design. Exact site dimensions, topography, existing utilities, soil conditions and drainage solutions.

WARNING: Accessible safety surfacing material is required beneath and around this equipment that has a critical height value (Fall Height) appropriate for the highest accessible part of this equipment. Refer to the CPSC'S Handbook For Public Playground Safety, Section 4: Surfacing.

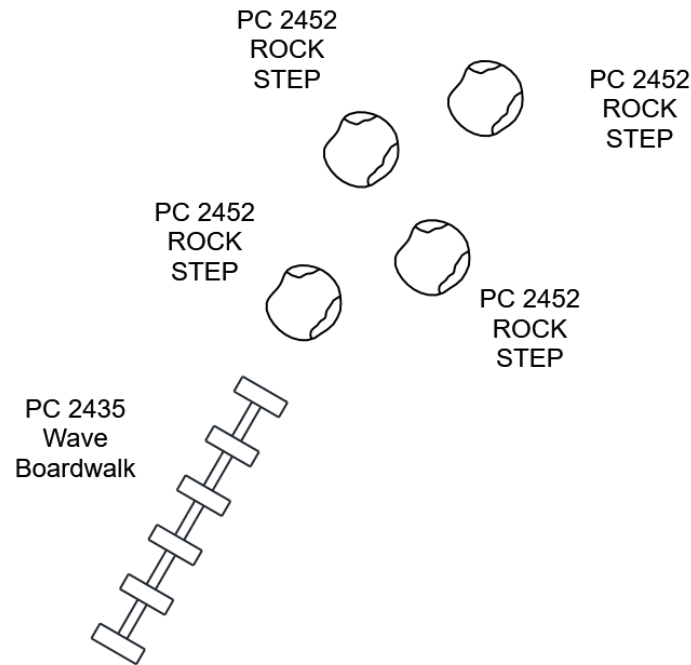

STRUCTURE#: 5
PROJECT#: 08152021
DATE: 10/10/2021

MIN. USE ZONE: 21' x 24'

PLAYCRAFT REP:
Play Environments Design, LLC

Acme Twp, Bayside Park

TOP VIEW

ADA ACCESSIBILITY GUIDELINE - ADAAG CONFORMANCE

ELEVATED	ACCESSIBLE	RAMP ACCESSIBLE	GROUND	TYPES
0	0/0	0	1/0	1/0

FOR KIDS
AGES
5-12

GENERAL NOTES:

This conceptual plan is based on information provided prior to construction. Detailed site information, including the following, should be obtained, evaluated, and utilized in the final project design. Exact site dimensions, topography, existing utilities, soil conditions and drainage solutions.

WARNING: Accessible safety surfacing material is required beneath and around this equipment that has a critical height value (Fall Height) appropriate for the highest accessible part of this equipment. Refer to the CPSC'S Handbook For Public Playground Safety, Section 4: Surfacing.

PC 2495 MERRY-GO-ROUND

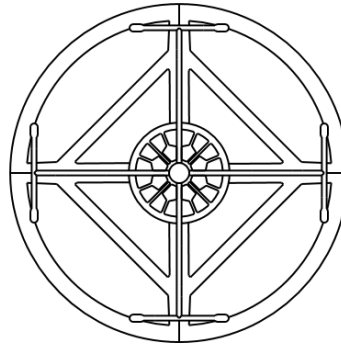

STRUCTURE#: 7
PROJECT#: 08152021
DATE: 10/10/2021

MIN. USE ZONE: 20' x 20'

PLAYCRAFT REP:
Play Environments Design, LLC

Acme Twp, Bayside Park

TOP VIEW

ADA ACCESSIBILITY GUIDELINE - ADAAG CONFORMANCE

ELEVATED	ACCESSIBLE	RAMP ACCESSIBLE	GROUND	TYPES
0	0/0	0	1/0	1/0

FOR KIDS
AGES
5-12

PC 2485
NEUTRON
SPINNER

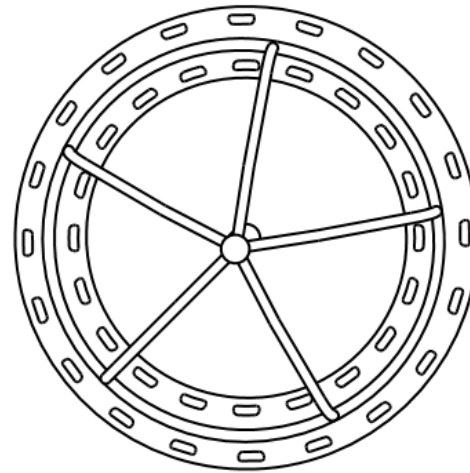

GENERAL NOTES:

This conceptual plan is based on information provided prior to construction. Detailed site information, including the following, should be obtained, evaluated, and utilized in the final project design. Exact site dimensions, topography, existing utilities, soil conditions and drainage solutions.

WARNING: Accessible safety surfacing material is required beneath and around this equipment that has a critical height value (Fall Height) appropriate for the highest accessible part of this equipment. Refer to the CPSC'S Handbook For Public Playground Safety, Section 4: Surfacing.

STRUCTURE#: 8
PROJECT#: 08152021
DATE: 10/10/2021

MIN. USE ZONE: 25' x 25'

PLAYCRAFT REP:
Play Environments Design, LLC

Acme Twp, Bayside Park

TOP VIEW

ADA ACCESSIBILITY GUIDELINE - ADAAG CONFORMANCE

ELEVATED	ACCESSIBLE	RAMP ACCESSIBLE	GROUND	TYPES
0	0/0	0	1/0	1/0

FOR KIDS
AGES
5-12

GENERAL NOTES:

This conceptual plan is based on information provided prior to construction. Detailed site information, including the following, should be obtained, evaluated, and utilized in the final project design. Exact site dimensions, topography, existing utilities, soil conditions and drainage solutions.

WARNING: Accessible safety surfacing material is required beneath and around this equipment that has a critical height value (Fall Height) appropriate for the highest accessible part of this equipment. Refer to the CPSC'S Handbook For Public Playground Safety, Section 4: Surfacing.



PC 1395
DUAL
AIRPLANE
SPRING
RIDER

STRUCTURE#: 9
PROJECT#: 08152021
DATE: 10/10/2021

MIN. USE ZONE: 13' x 16'

PLAYCRAFT REP:
Play Environments Design, LLC

Acme Twp, Bayside Park

TOP VIEW

ADA ACCESSIBILITY GUIDELINE - ADAAG CONFORMANCE

ELEVATED	ACCESSIBLE	RAMP ACCESSIBLE	GROUND	TYPES
0	0/0	0	1/0	1/0

R35

FOR KIDS
AGES
5-12

GENERAL NOTES:

This conceptual plan is based on information provided prior to construction. Detailed site information, including the following, should be obtained, evaluated, and utilized in the final project design. Exact site dimensions, topography, existing utilities, soil conditions and drainage solutions.

WARNING: Accessible safety surfacing material is required beneath and around this equipment that has a critical height value (Fall Height) appropriate for the highest accessible part of this equipment. Refer to the CPSC'S Handbook For Public Playground Safety, Section 4: Surfacing.

Surf
Rider



STRUCTURE#: 10
PROJECT#: 08152021
DATE: 10/10/2021

MIN. USE ZONE: 18' x 15'

PLAYCRAFT REP:
Play Environments Design, LLC

Acme Twp, Bayside Park

TOP VIEW

ADA ACCESSIBILITY GUIDELINE - ADAAG CONFORMANCE

ELEVATED	ACCESSIBLE	RAMP ACCESSIBLE	GROUND	TYPES
5	5/3	0	4/2	1/2

R5

FOR KIDS
AGES
5-12

GENERAL NOTES:

This conceptual plan is based on information provided prior to construction. Detailed site information, including the following, should be obtained, evaluated, and utilized in the final project design. Exact site dimensions, topography, existing utilities, soil conditions and drainage solutions.

WARNING: Accessible safety surfacing material is required beneath and around this equipment that has a critical height value (Fall Height) appropriate for the highest accessible part of this equipment. Refer to the CPSC'S Handbook For Public Playground Safety, Section 4: Surfacing.

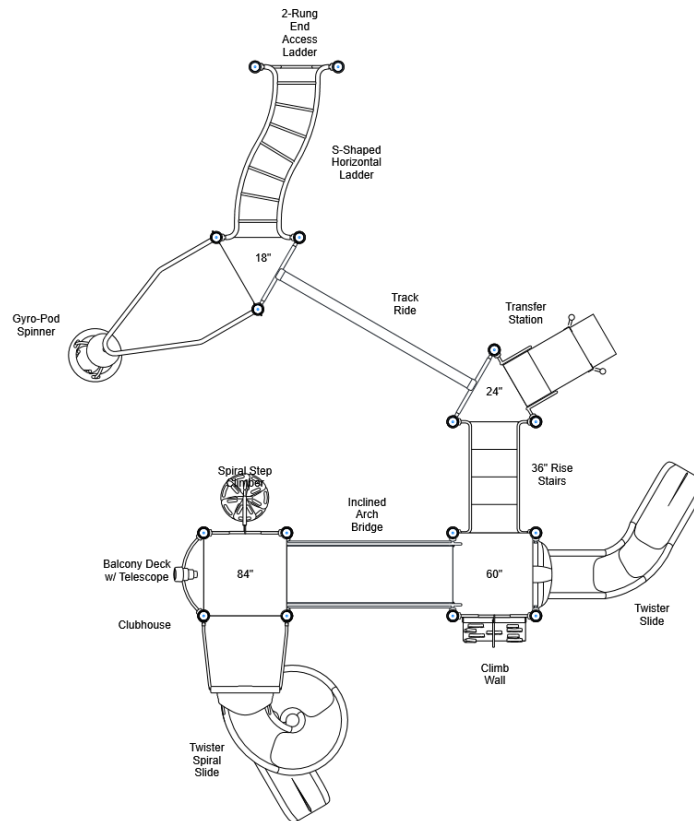

STRUCTURE#: 12
PROJECT#: 08152021
DATE: 10/10/2021

MIN. USE ZONE: 41' x 48'

PLAYCRAFT REP:
Play Environments Design, LLC

Acme Twp, Bayside Park

TOP VIEW

ADA ACCESSIBILITY GUIDELINE - ADAAG CONFORMANCE

ELEVATED	ACCESSIBLE	RAMP ACCESSIBLE	GROUND	TYPES
5	5/3	0	2/2	1/2

R5

FOR KIDS
AGES
2-5

GENERAL NOTES:

This conceptual plan is based on information provided prior to construction. Detailed site information, including the following, should be obtained, evaluated, and utilized in the final project design. Exact site dimensions, topography, existing utilities, soil conditions and drainage solutions.

WARNING: Accessible safety surfacing material is required beneath and around this equipment that has a critical height value (Fall Height) appropriate for the highest accessible part of this equipment. Refer to the CPSC'S Handbook For Public Playground Safety, Section 4: Surfacing.

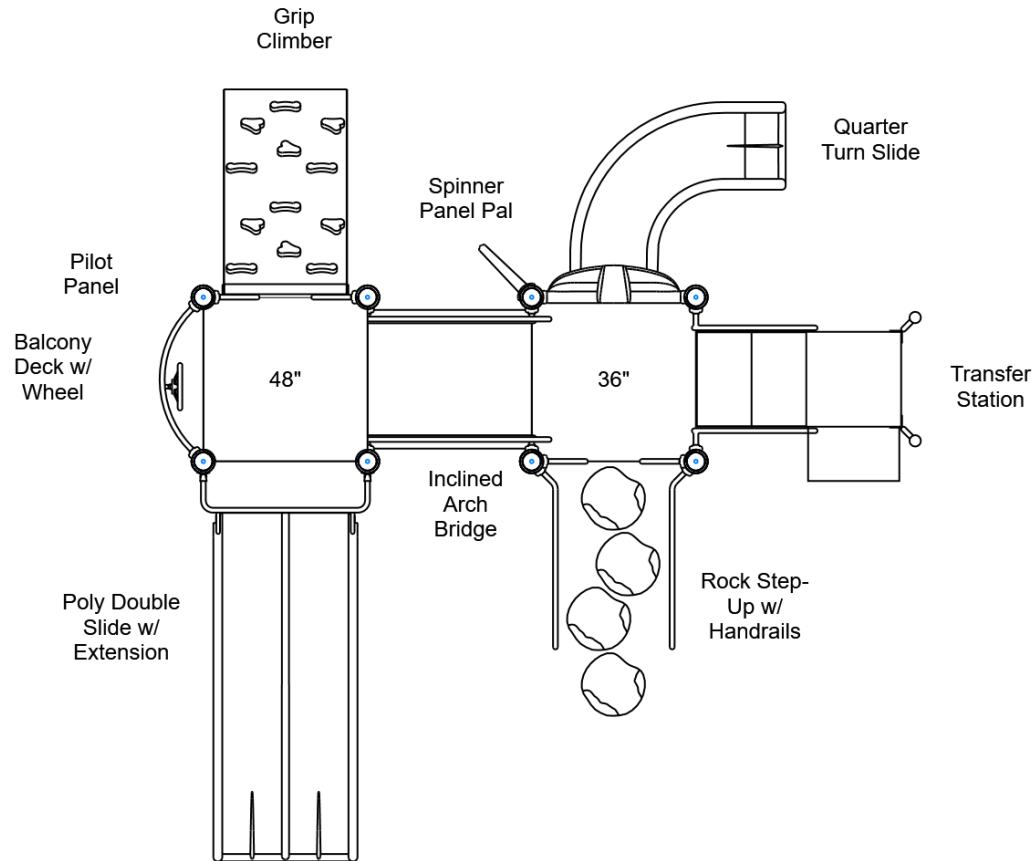

STRUCTURE#: 13
PROJECT#: 08152021
DATE: 10/10/2021

MIN. USE ZONE: 30' x 30'

PLAYCRAFT REP:
Play Environments Design, LLC

Acme Twp, Bayside Park

SITE PLAN

ADA ACCESSIBILITY GUIDELINE - ADAAG CONFORMANCE

ELEVATED	ACCESSIBLE	RAMP ACCESSIBLE	GROUND	TYPES
10	10/5	0	22/3	10/3

Mixed
Types

FOR KIDS
AGES
[Mixed]

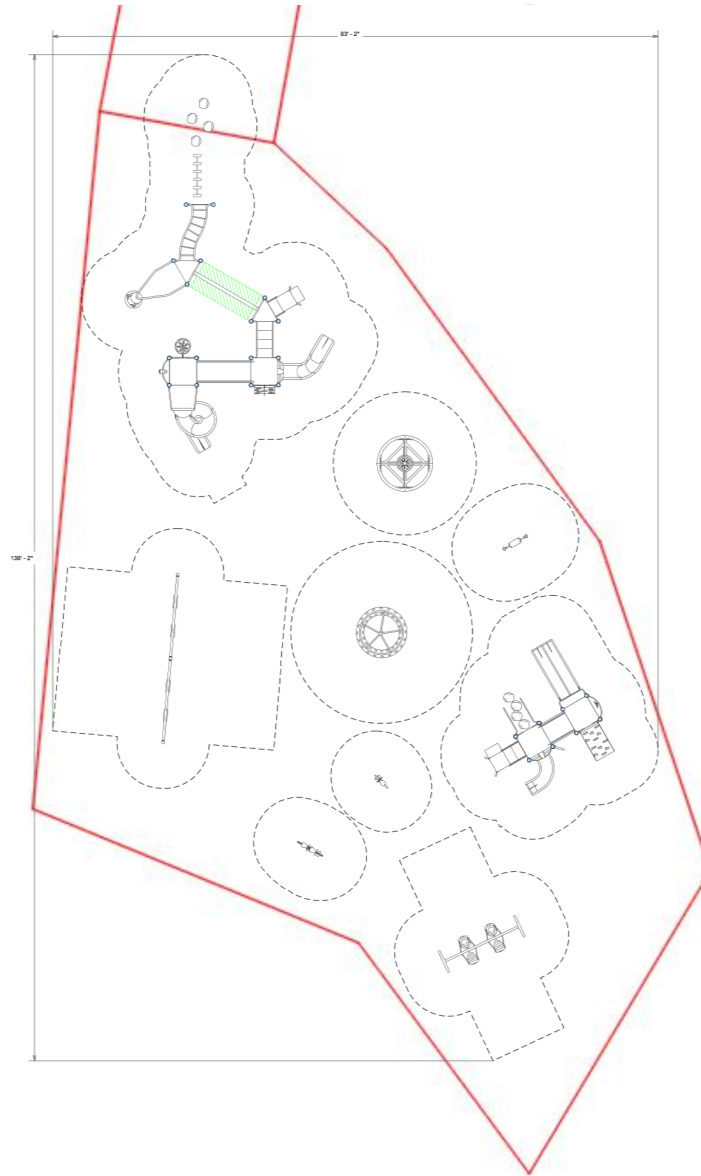

GENERAL NOTES:

This Preliminary Site Plan is based on measurements that were provided in the initial planning phase. All dimensions must be verified prior to the submission of a purchase order. Playcraft Systems will not be held responsible for any discrepancies between actual dimensions and dimensions submitted in the planning phase.

The Minimum Use Zone for a play structure is based on the product design at the time of proposal. Components and structure designs may be subject to change which may affect dimensions. Therefore, before preparing the site, we strongly recommend obtaining final drawings from the factory (available after the order is placed and included in the Assembly Manual).

WARNING: Accessible safety surfacing material is required beneath and around this equipment that has a critical height value (Fall Height) appropriate for the highest accessible part of this equipment. Refer to the CPSC'S Handbook For Public Playground Safety, Section 4: Surfacing.

PROJECT#: 08152021

DATE: 10/10/2021

MIN. USE ZONE: 84' x 139'

PLAYCRAFT REP:

Play Environments Design, LLC

Acme Twp, Bayside Park
SW VIEW

FOR KIDS
AGES
5-12



STRUCTURE#: 2
PROJECT#: 08152021
DATE: 10/10/2021

Acme Twp, Bayside Park
SW VIEW

FOR KIDS
AGES
2-5

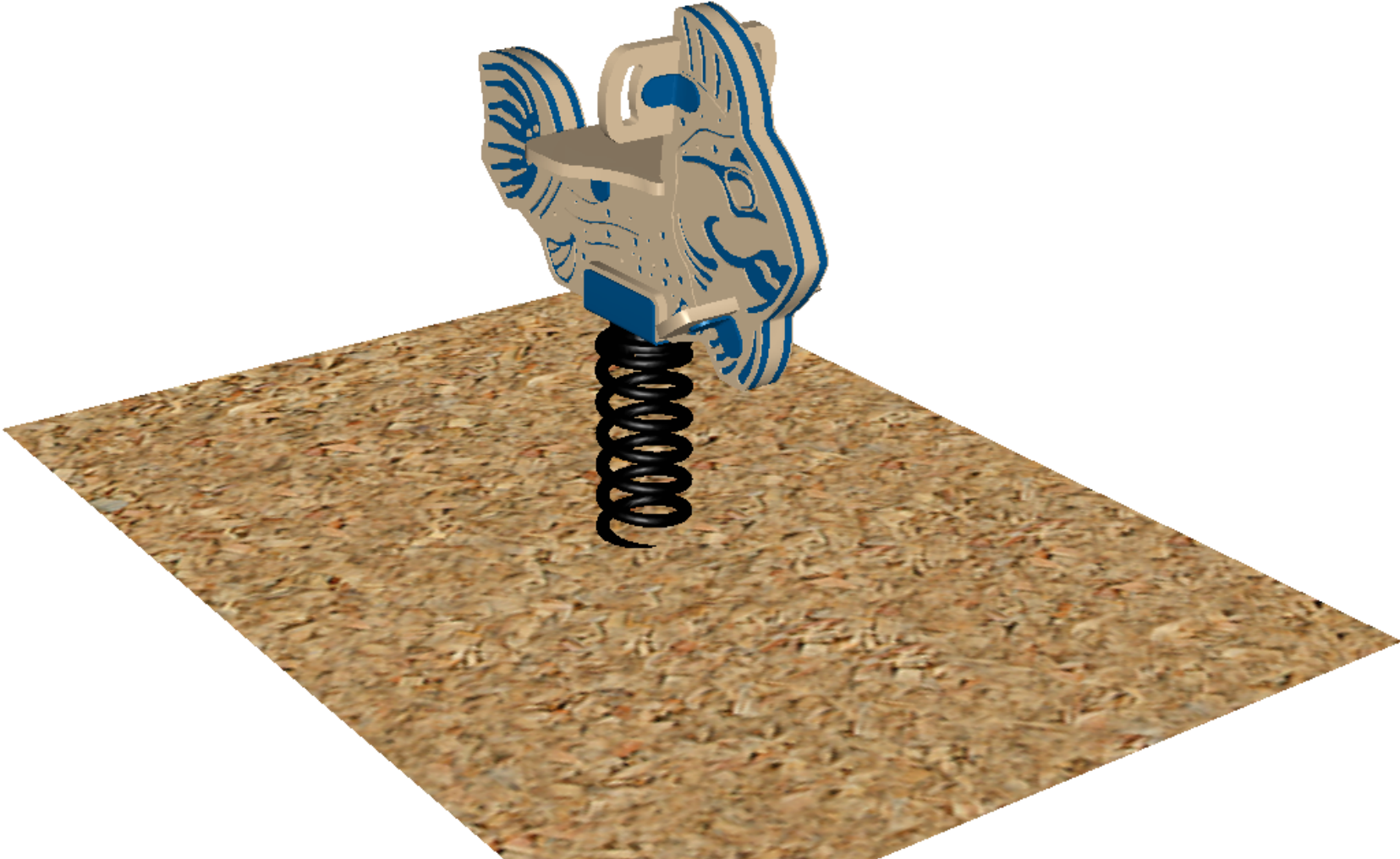

STRUCTURE#: 3
PROJECT#: 08152021
DATE: 10/10/2021

Acme Twp, Bayside Park
SW VIEW

FOR KIDS
AGES
5-12

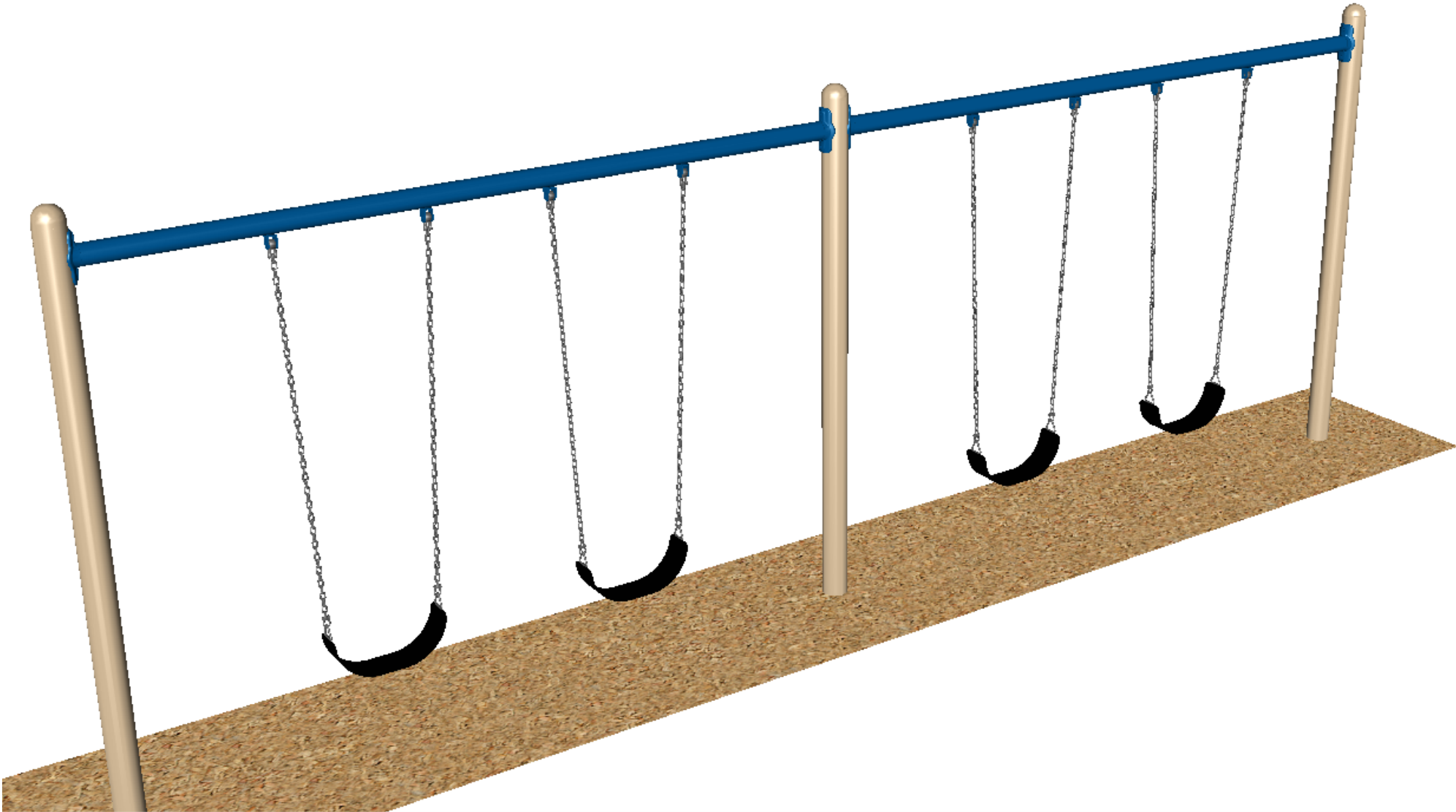

STRUCTURE#: 4
PROJECT#: 08152021
DATE: 10/10/2021

Acme Twp, Bayside Park
SW VIEW

FOR KIDS
AGES
5-12

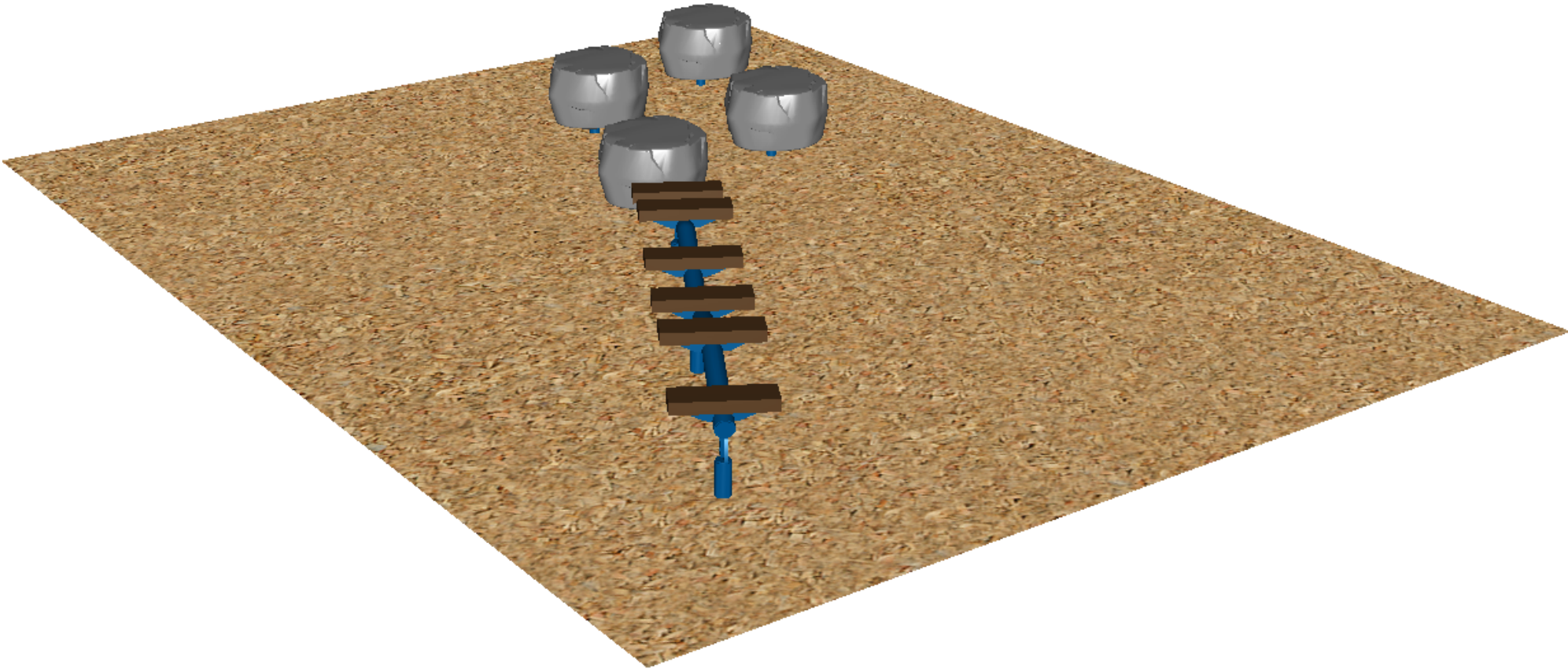

STRUCTURE#: 5
PROJECT#: 08152021
DATE: 10/10/2021

Acme Twp, Bayside Park
SW VIEW

FOR KIDS
AGES
5-12

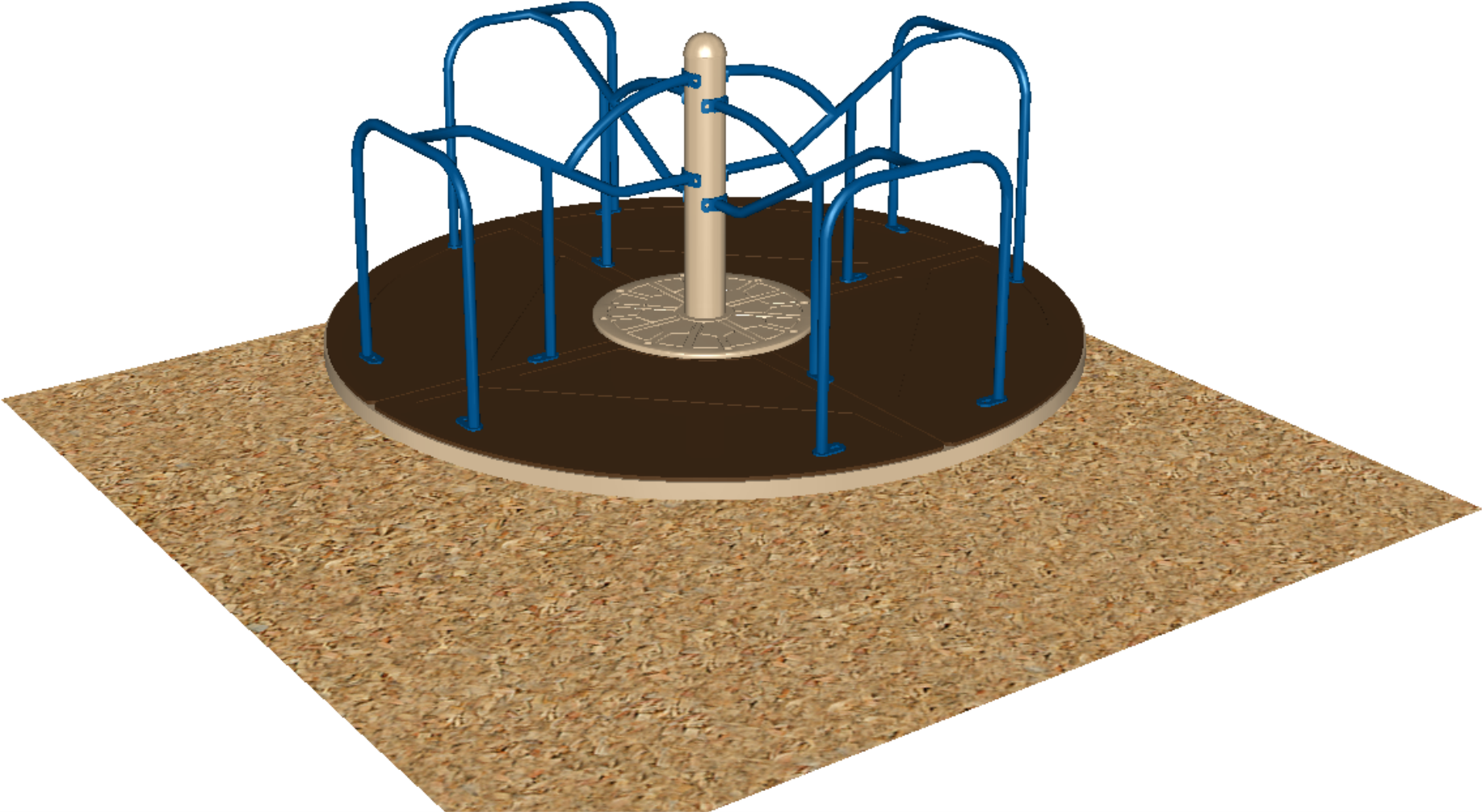

STRUCTURE#: 7
PROJECT#: 08152021
DATE: 10/10/2021

Acme Twp, Bayside Park
SW VIEW

FOR KIDS
AGES
5-12



STRUCTURE#: 8
PROJECT#: 08152021
DATE: 10/10/2021

Acme Twp, Bayside Park
SW VIEW

FOR KIDS
AGES
5-12

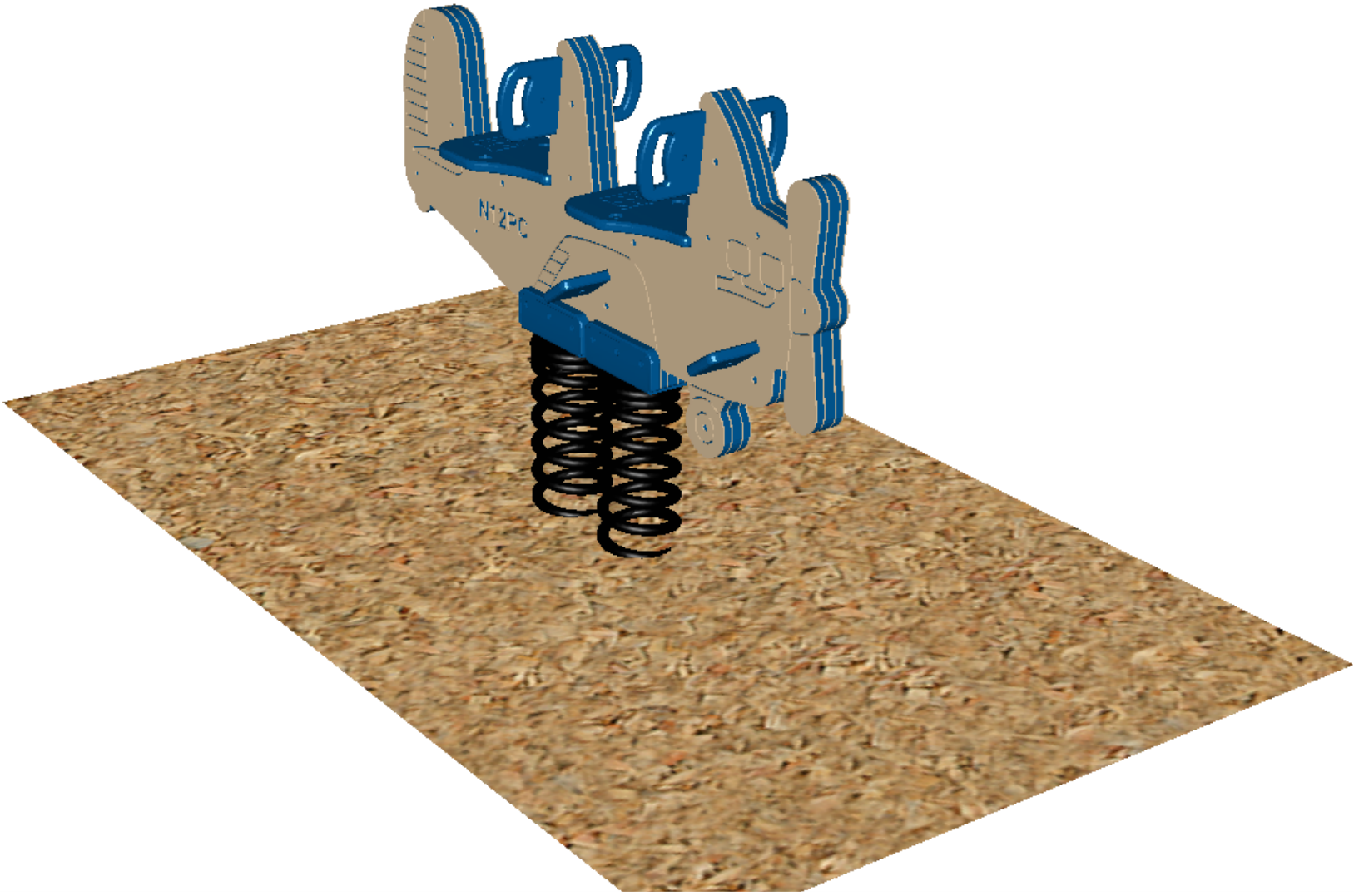

STRUCTURE#: 9
PROJECT#: 08152021
DATE: 10/10/2021

Acme Twp, Bayside Park
SW VIEW

R35

FOR KIDS
AGES
5-12

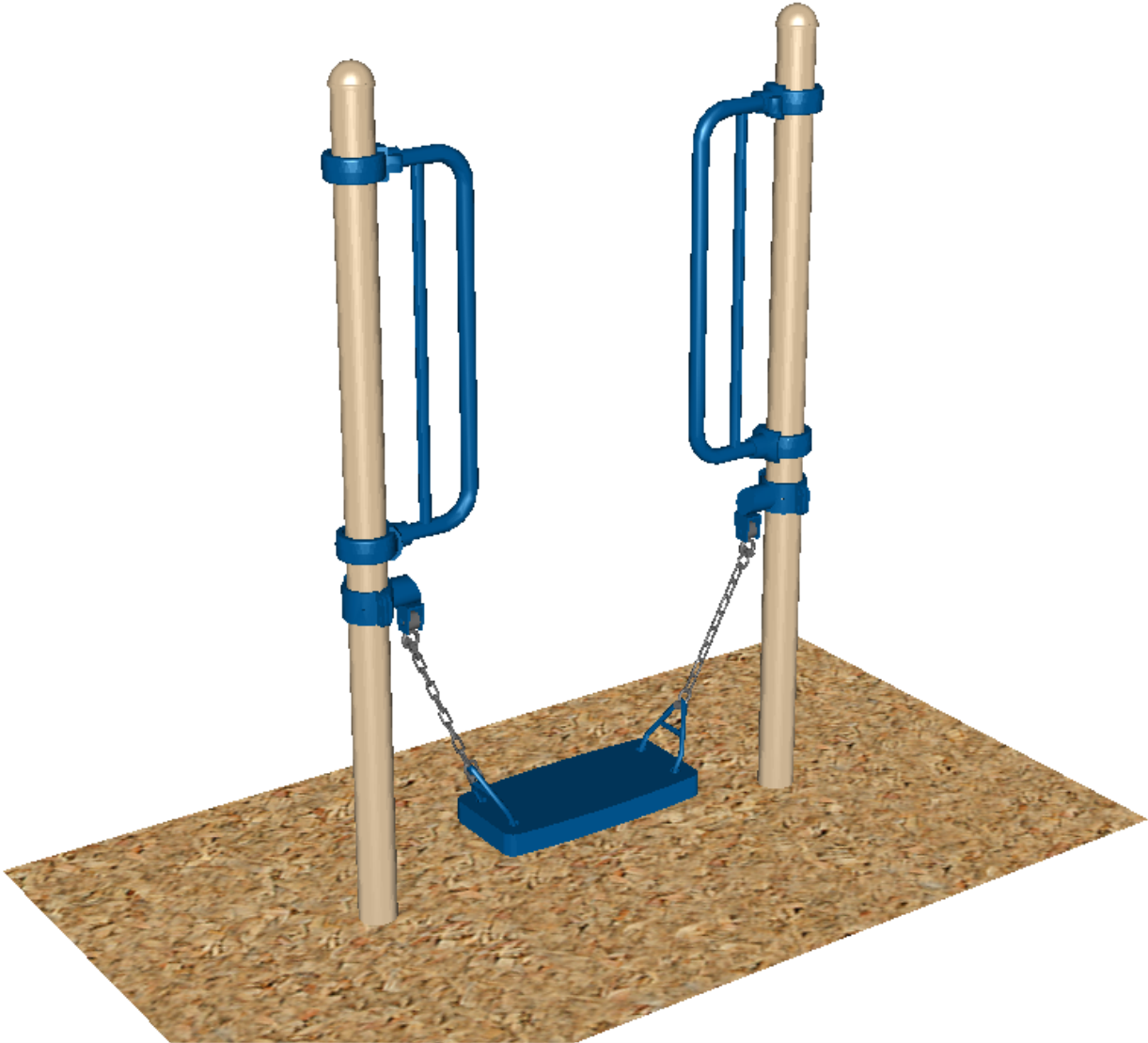

STRUCTURE#: 10
PROJECT#: 08152021
DATE: 10/10/2021

Acme Twp, Bayside Park
SW VIEW

R5

FOR KIDS
AGES
5-12



STRUCTURE#: 12
PROJECT#: 08152021
DATE: 10/10/2021

Acme Twp, Bayside Park
NE VIEW

R5

FOR KIDS
AGES
5-12



STRUCTURE#: 12
PROJECT#: 08152021
DATE: 10/10/2021

Acme Twp, Bayside Park
SW VIEW

R5

FOR KIDS
AGES
2-5



STRUCTURE#: 13
PROJECT#: 08152021
DATE: 10/10/2021

Acme Twp, Bayside Park
NE VIEW

R5

FOR KIDS
AGES
2-5



STRUCTURE#: 13
PROJECT#: 08152021
DATE: 10/10/2021



Bill of Materials

Acme Twp, Bayside Park

Project# 08152021

10/10/2021

Item	Description	Quantity
2-5 Swing		
A2-2123-PSX2	PC 2123 Arch Swing (2PS)	1
Spring Toy		
A2-1384	PC 1384 Fish Spring Rider	1
5-12 Swings		
A2-2181-2B	PC 2181-8 8ft Single Post Swing (2B)	1
A2-2181-2B-AB	PC 2181-8 8ft Single Post AB (R, 2B)	1
Functional Link Events		
A2-2435-W	PC 2435 Boardwalk, Wave	1
S-1961-R	PC 2452 Rock Step	4
Merry-Go-Round		
A2-2495	PC 2495 Merry-Go-Round	1
Neutron Spinner		
A2-2485	PC 2485 Neutron Spinner	1
Spring Toy 2		
A2-1395	PC 1395 Dual Airplane Spring Rider	1
Surf Rider		
HS-1004-R35	Collars	4
GG-8135	Dome Cap, R3.5	2
S-1009-R35-09ft	Post, 09ft R3.5	2
S-1948-R35	Surf Rider	1
5-12 Structure R5		
HS-1004-R	Collars	45
GF-7002	Dome Cap, R5	16
S-1010-R5-10ft	Post, 10ft R5	1
S-1011-R5-11ft	Post, 11ft R5	7



Bill of Materials (continued)

Item	Description	Quantity
S-1012-R5-12ft	Post, 12ft R5	4
S-1014-R5-14ft	Post, 14ft R5	4
S-1101-R5	Square Deck	2
S-1102-R5	Tri-Deck	2
S-1109-R5-T	Balcony Deck w/ Telescope	1
S-1206-36R5	ADA Stairs, 36in Rise w/ Walls	1
S-1209-12-R5	Transfer Station, 24in-C	1
S-1214-5R5	Climber, Wall 54-60in	1
S-1234-7R	Climber, Spiral Step 78-84in	1
S-1303-TW-R5	Twister Entry Panel w/ Hood	1
S-1310-R5	Transition Wall	2
S-1402-R5	End Access Ladder (2-Rung)	1
S-1405-R-R5	Traverse, Horizontal Ladder (S-Shaped, Right)	1
S-1413-R10	Traverse, Track Ride (122in)	1
S-1514-90R5	Bridge, Inclined Arch (90in)	1
S-1639-R5	Clubhouse	1
S-1706-S7L-R5	Slide, Twister Spiral 84in (L)	1
S-1710-5-LL	Slide, Twister 60in (L2)	1
S-1974-R5	Gyro-Pod Spinner	1
HS-1007-R5	Extra Hardware	2
2-5 Structure R5		
HS-1004-R	Collars	24
GF-7002	Dome Cap, R5	8
S-1010-R5-10ft	Post, 10ft R5	4
S-1011-R5-11ft	Post, 11ft R5	4
S-1101-R5	Square Deck	2
S-1109-R5-MT	Balcony Deck w/ Wheel	1
S-1209-24-R5	Transfer Station, 36in-L	1
S-1216-4	Climber, Grip 42-48in	1
S-1303-R5	Single Slide SitDown Hood	1



**Bill of Materials
(continued)**

Item	Description	Quantity
S-1309-2-R5	Half Walls (Pair) R5	2
S-1514-45R5	Bridge, Inclined Arch (45in)	1
S-1643-R5G	Pilot Panel	1
S-1666-R5	Panel Pal, Spinner	1
S-1702-1122-4	Slide, Wave 48in (Double, w/ Extn)	1
S-1705-3	Slide, Quarter Turn 36in	1
S-1961-3-HH-R5	Climber, Step-Up 36in (Rock, Hand Rails)	1
HS-1007-R5	Extra Hardware	2